



Technical Specifications

LD3xi™ Compression Load Cell

Process Tank Weighing for Wet-To-Sanitary Operating Conditions

The LD3xi shares many common features to Kistler-Morse's LD360s but features higher accuracies for smaller-capacity weighing applications and is available in weight ranges between 220 lbs. and 5,500 lbs.

The LD3xi is a rugged, stainless steel load cell for in-process tanks and bulk storage vessels. It combines vessel "hold-down" with unprecedented cleanability. It continuously measures the weight of the tank, providing batching information control, and supplies material-on-hand information for a variety of applications.

Its sealed, stainless steel construction, as well as its unique NEMA-6P rated cable system, makes the LD3xi ideal for use in high-pressure, wash-down environments where cleaning and sanitizing chemicals are used. The LD3xi is particularly suitable for use on mixing and blending vessels, surge hoppers and vessels with agitators.

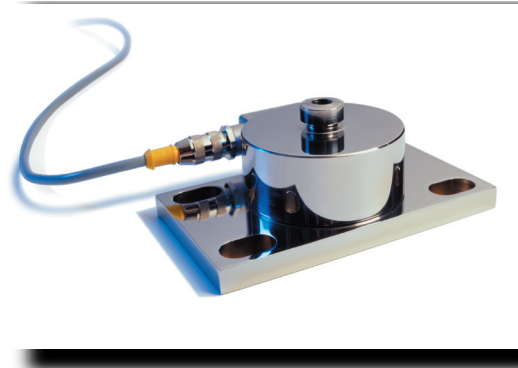

Features & Benefits

Cleanability and Strength For CIP/SIP

Built-in vessel hold-down eliminates mechanical pivot points, a source of bacteria traps and system errors caused by hardware gradually binding. Less operator time spent cleaning.

NEMA-6P / IP68 Submersion Rating, 17-4 ph 900 SS Construction

Unsurpassed waterproof protection and corrosion resistance for long life in rigorous CIP wash down areas. First load cell ever with a sealed cabling system option.

Minimal Deflection

Better system performance on tanks with pipes and process plumbing connections.

LD3xi Specifications

Mechanical

Compression: 3 x rated load

Tension: 1 x rated load

Shear (capacity 220 lbs -2200 lbs): 0.5 x rated load
(capacity 5500 lbs): 0.25 x rated load

Functional Integrity: 1.5 x rated load (compression)

Electrical

Excitation Voltage - Operating Range: 5-15 VDC

Recommended Supply Voltage: 10 VDC

Maximum Current: 16mA @ 10 VDC excitation (0-F)

Output Resistance: 705 ohms +/- 2%

Output

Non-linearity/Hysteresis combined:

0.03% rated output

Return to Zero over 30 min:

0.026% rated output

Creep over 30 min: 0.028% rated output

Creep over 20 and 30 min: 0.008% rated output

Zero Balance: 1% rated output

Rated Output: 2 mV/V +/-0.1%

Deflection: 0.004"-0.008" for capacities 220-5500 lbs

Environmental

Temperature Range - Standard:

14° to 104° F (-10° to 40° C)

Temperature Zero Shift: 0.0013%/°F (0.0024%/°C)

Temperature Sensitivity Change:

0.00094% /°F (0.0017% /°C)

Storage Temp Range: -4° to 176°F (-20°C to 80°C)

Humidity: 100%

Physical

Construction: 17-4 PH 900 stainless steel

Connector : optional 6P rated sealed 5-conductor,
12mm male receptacle

Cable : 4-conductor, 22 gage shielded, 16 ft. (5m) long,
with tinned pigtail termination

Rating: IP68 (100h at 1m water column)

Shipping Weight: 5 lbs (2.3 kg)

DIMENSIONS	
Base Plate Size Length x Width	6.00" [152.4mm] x 3.50" [88.9mm]
Installed Height LD3xi W/UA3xi LD3xi W/LT3xi LD3xi W/AD3xi	2.73" [69.3mm] MIN: 5.00" [127mm] MAX: 5.17" [131.3mm] MIN: 5.00" [127mm] MAX: 5.17" [131.3mm]
Top Plate Size Length x Width UA3xi LT3xi AD3xi	6.00" [152.4mm] x 3.50" [88.9mm] 6.00" [152.4mm] x 3.50" [88.9mm] 6.00" [152.4mm] x 6.00" [152.4mm]

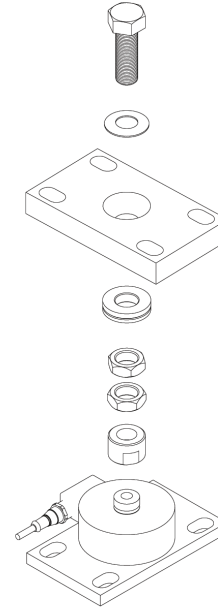

LD3xi with LT3xi Leveling Top Adapter Plate

Ordering Information			
LD3xi-a-b-c-d			
[a] Transducer Accuracy		Top Installation Hardware	
[b] Rated Load		AD3XI	Anyadapter Leveling Top Adapter Plate
220	220 lbs (100 kg)	LT3XI	Leveling Top Adapter Plate
550	550 lbs (250 kg)	NO	No Hardware
1100	1100 lbs (500 kg)	UA3XI	Universal Top Adapter Plate
2200	2200 lbs (1000 kg)		
5500	5500 lbs (2500 kg)		
[c] Cabling Connector		Additional Hardware	
X	Attached 5-meter pigtail cable (Standard)	LB3XI	Leveling Base Adapter Plate
[d] Finish		Warranty	
X	Brushed	X	Standard 1 yr warranty

P/N 97-7071-06 Rev A
 Specifications subject to change without notice.
 ©2006, Kistler-Morse. All rights reserved.

KM is represented in your area by:



WORLD HEADQUARTERS
 150 Venture Boulevard
 Spartanburg, SC 29306 USA
1.800.426.9010
 tel: 864.574.2763
 fax: 864.574.8063
 kistlermorse.com

