



Technical Specifications

LD3xiC™ Compression Load Cell

Process Tank Weighing For Dry-To-Wet Operating Conditions

From bakery, pasta, confectionary and spice processing to resins, concrete/aggregate, sand, pulp, minerals and other dry-to-wet operating conditions, the full bridge, foil gauge LD3xiC offers very specific advantages not available in most higher-priced load cells. Standards include a tough “cage” mounting fixture into which the 17-4 stainless steel LD3xiC load cell securely locks in place. Since the LD3xiC load cell can be installed before or after the tank is installed onto the “cage” fixture, you have more flexibility in mounting procedures. If ever the load cell needs to be replaced, it can be removed without having to remove the “cage” fixture itself. The LD3xiC is available in virtually all popular weight capacities from 11,000 lbs to 22,000 lbs. and is easy to specify due to identical dimensions and price throughout the uniform range.

This stainless steel load cell has been designed to ease the installation of weighing and batching systems, in tanks, bins and in static or vibrating hoppers.

The unique “cage” arrangement compensates for minor structure misalignment and offsets side loads due to positioning errors, thermal tank expansion, etc., while providing a high-strength structural support.

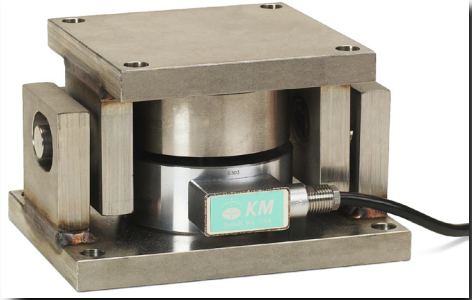

Features & Benefits

Easy to Install and Access

Sensor mounted into rugged “cage” fixture hardware which never requires removal in the event of load cell changeovers.

Single Footprint and Cost

Easy to design in, regardless the capacity.

Load Self Alignment

Ensures high performance.

All Stainless Steel Sensor Design

Beneficial in washdown environments for corrosion free sensor.

Self Checking and Overlift Protection Structure

No check rods needed.

High Functional Overload Capacity

Allows overloading vessel without damaging load cells.

Specifications

Mechanical

Compression: 3 x rated load

Tension: 1 x rated load *

Shear: 0.5 x rated load *

Functional Integrity: 1.5 x rated load (compression)

Electrical

Excitation Voltage - Operating Range: 5-15 VDC

Recommended Supply Voltage: 10 VDC

Maximum Current: 16mA @ 10 VDC excitation (0-F)

Input Resistance: 700 ohms ± 2 ohms

Insulation Resistance: > 5 megohms

Output

Non-linearity/Hysteresis combined:

0.03% rated output

Return to Zero over 30 min:

0.026% rated output

Creep over 30 min: 0.028% rated output

Creep over 20 and 30 min: 0.008% rated output

Zero Balance: 1% rated output

Rated Output: 2 mV/V ± 0.1%

Output Resistance: 705 ohms ± 2 ohms

Environmental

Temperature Range - Standard:

14° to 104° F (-10° to 40° C)

Temperature Zero Shift: 0.0013%/°F (0.0024%/°C)

Temperature Sensitivity Change:

0.00094%/°F (0.0017%/°C)

Storage Temp Range: -4° to 176° F (-20° C to 80° C)

Humidity: 100%

Physical

Construction (load cell and cage): 17-4 PH 900 stainless steel

Cable : 4-conductor, 22 gage shielded, 16 ft. (5m) long, with tinned pigtail termination

Rating: IP68 (100h at 1m water column)

Shipping Weight: 18.7 lbs (8.5 kg)

Approvals:



* Tension and shear strength are for the load disc only. The "cage" design effectively de-couples the sensor from tension and shear loads.

DIMENSIONS

Base Plate Size Length x Width	6.00" [152.4mm] x 3.50" [88.9mm]
Installed Height LD3xi W/UA3xi LD3xi W/LT3xi LD3xi W/AD3xi	2.73" [69.3mm] MIN: 5.00" [127mm] MAX: 5.17" [131.3mm] MIN: 5.00" [127mm] MAX: 5.17" [131.3mm]
Top Plate Size Length x Width UA3xi LT3xi AD3xi	6.00" [152.4mm] x 3.50" [88.9mm] 6.00" [152.4mm] x 3.50" [88.9mm] 6.00" [152.4mm] x 6.00" [152.4mm]

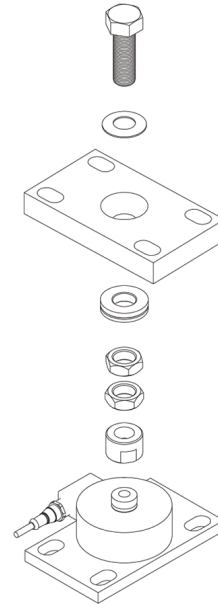

LD3xi with LT3xi Leveling Top Adapter Plate

Ordering Information			
LD3xi-a-b-c-d			
[a] Transducer Accuracy		Top Installation Hardware	
[b] Rated Load		AD3XI	Anyadapter Leveling Top Adapter Plate
220	220 lbs (100 kg)	LT3XI	Leveling Top Adapter Plate
550	550 lbs (250 kg)	NO	No Hardware
1100	1100 lbs (500 kg)	UA3XI	Universal Top Adapter Plate
2200	2200 lbs (1000 kg)		
5500	5500 lbs (2500 kg)		
[c] Cabling Connector		Additional Hardware	
X	Attached 5-meter pig-tail cable (Standard)	LB3XI	Leveling Base Adapter Plate
[d] Finish		Warranty	
X	Brushed	X	Standard 1 yr warranty

P/N 97-7071-05 Rev. A
Specifications subject to change without notice.
©2006, Kistler-Morse. All rights reserved.

KM is represented in your area by:



WORLD HEADQUARTERS
150 Venture Boulevard
Spartanburg, SC 29306 USA
1.800.778.9242
tel: 864.574.8060
fax: 864.574.8063
kistlermorse.com

